

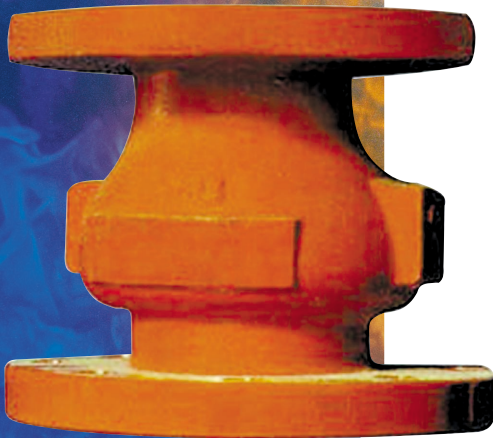

Lifeco



Approved.



Flanged End Ductile Iron Body Check Valve

- Ductile Iron Body with EPDM Seat. Bronze plate.
- 250 Lb. Dualplate. UL Listed. FM Approved.
- Model 453UF(250) End flanges conform to ANSI B16.1 CLASS 250
- Model 453UF(125) End flanges conform to ANSI B16.1 CLASS 125
- Model 453UF(PN16) End flanges conform to BS EN-1092 PN16

Material List

No	Part	Material	ASTM SPEC.
1	Body	Ductile Iron	A536
2	Body Seal	EPDM	
3	Disc	Cast Bronze	B62(C83600)
4	Spring	Stainless Steel	AISI 316
5	Hinge Pin	Stainless Steel	AISI 316
6	Washer	Teflon	
7	Thrust Washer	Teflon	
8	Plug	Mild Steel	A105-80
9	Washer	Teflon	
10	Square Plug	Mild Steel	A105-80

453UF (250#)

Nominal Size	Dimensions Unit: Inch							Net. Wt	
	L	C	D	R	T	"M"PT	h x n	Kg	
3"	6 ⁵ / ₈	6 ⁵ / ₈	8 ¹ / ₄	15 ¹¹ / ₁₆	1 ¹ / ₈	1 ¹ / ₂	7 ⁷ / ₈ x8	10.5	
4"	7 ¹ / ₂	7 ⁷ / ₈	10	6 ¹⁵ / ₁₆	1 ¹ / ₄	1 ¹ / ₂	7 ⁷ / ₈ x8	16.7	
6"	9	10 ⁵ / ₈	12 ¹ / ₂	9 ¹¹ / ₁₆	1 ⁷ / ₁₆	3 ³ / ₄	7 ⁷ / ₈ x12	28.6	
8"	10 ¹ / ₂	13	15	11 ¹⁵ / ₁₆	1 ⁵ / ₈	3 ³ / ₄	1x12	46.2	

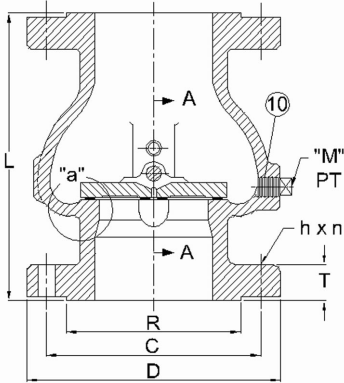

453UF (PN16)

Nominal Size	Dimensions Unit: mm							Net. Wt	
	L	C	D	R	T	"M"PT	h x n	Kg	
DN80	168.3	160	200	132	22	1 ¹ / ₂	19x8	10.5	
DN100	190.5	180	220	156	24	1 ¹ / ₂	19x8	16.7	
DN150	241.3	240	285	211	26	3 ³ / ₄	23x8	28.6	
DN200	298.5	295	340	266	26	3 ³ / ₄	23x12	46.2	

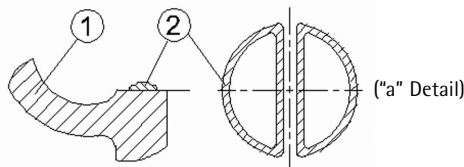
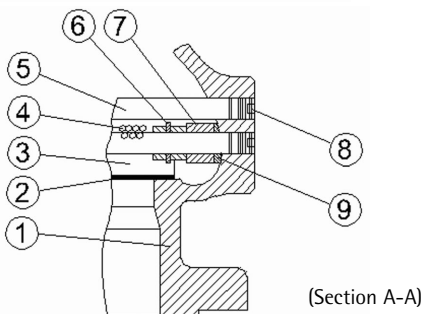

453UF (125#)

Nominal Size	Dimensions Unit: Inch						Net. Wt	
	L	C	D	T	"M"PT	h x n	Lbs	
3"	6 ⁵ / ₈	6	7 ¹ / ₂	3 ³ / ₄	1 ¹ / ₂	7 ⁷ / ₈ x8	23.2	
4"	7 ¹ / ₂	7 ¹ / ₂	9	1 ¹⁵ / ₁₆	1 ¹ / ₂	7 ⁷ / ₈ x8	36.7	
6"	9	9 ¹ / ₂	11	1	3 ³ / ₄	7 ⁷ / ₈ x12	62.9	
8"	10 ¹ / ₂	11 ³ / ₄	13 ¹ / ₂	1 ¹ / ₈	3 ³ / ₄	1x12	101.6	

Lichfield Fire & Safety Equipment Co. Ltd

2nd Floor, Suite 4, Saturn Centre,
Spring Road, Ettingshall,
Wolverhampton, WV4 6JX
United Kingdom

Tel: +44 (0) 870 066 4401
Fax: + 44 (0) 870 066 4402
E-mail: info@lifeco-uk.com
www.lifeco-uk.com

