

# TECHNICAL DATA SHEET



## Electric Solenoid

Part No.: LF 50025-2

Part No.: LF 91225-2

# LIFECO-227

HFC-227-EA Gas Extinguishing System

### DESCRIPTION

The Electric Solenoid valve is a normally closed valve that requires electrical energy to open. It is used to vent the pressure from the top of the piston in the cylinder valve, allowing the piston to slide upward and commence cylinder discharge. The electric solenoid valves are available in 24 VDC. The source of the electrical energy will determine the number and rating of the electric solenoid used. The solenoid circuit must be supervised for a break in the wiring, a ground or a short circuit.

The cylinder discharge valve that is equipped with a solenoid valve is to be connected to a control panel that is UL listed for releasing devices and compatible with SFFECO Fire Suppression equipment.

Connect solenoid pigtails to actuation circuit wires with wire nuts within a junction box or by means designated by the authority having jurisdiction.

Whenever an Electric Solenoid is used as the sole means of actuation, a top plug must be used to seal the top of the cylinder valve.

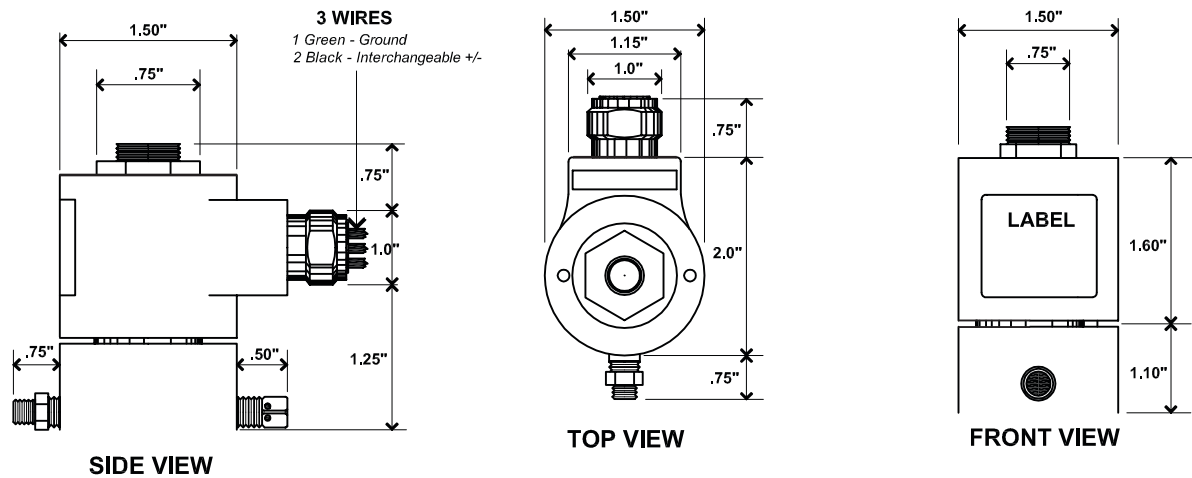

### Termination for Electric Solenoid (LF 50025-2)

Connect the terminals of the solenoid to the releasing module illustration shows in series. A third terminal (ground) is for grounding.

Most releasing circuits are supervised by an EOL (End of Line) Resistor

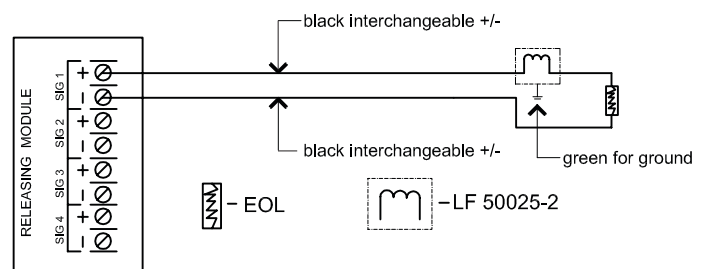

Part Number	Description	Electrical Rating
SF 50025-2	ELECTRIC SOLENOID	24 VDC, 11 Watts
SF 91225-2	ELECTRIC SOLENOID	24 VDC, 15 Watts

**NOTE:** Two 12 VDC solenoids can be wired in series in a 24 VDC actuating circuit.

## FOR USE BY ENGINEERS & ARCHITECTS



Lichfield Fire & Safety Equipment Co. Ltd | Unit 8, Calibre Industrial Park, Laches Close, Four Ashes, Wolverhampton, WV10 7DZ, United Kingdom

T +44 1902 798 706 F +44 1902 798 679 | E [sales@lifeco-uk.com](mailto:sales@lifeco-uk.com) | [www.lifeco-uk.com](http://www.lifeco-uk.com)