

## Schematic Drawing

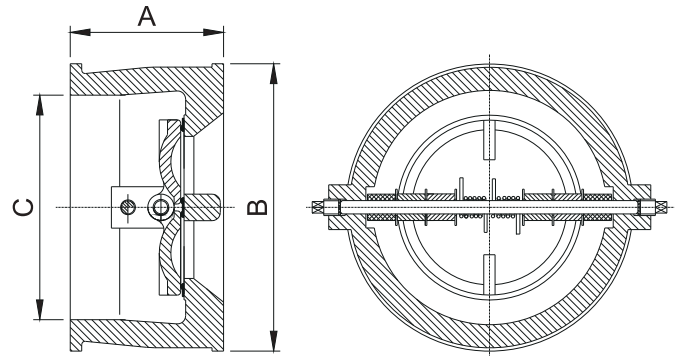

## Features

- 175 PSI Working Pressure
- -10° c to 120° c Working Temperature
- The extremely short face to face dimension and compact design of this valve allow installation and service in tight spaces.
- Spring assisted for better dynamic behaviour.
- Soft seated for perfect tightness even at low differential pressure.
- Flanges to ANSI B16. 1 Class125.
- Spray-painted or Fusion Bonded Epoxy Coated Interior and Exterior to AWWA C550 Standard.

## Material Specification

Component	Material
<b>Body</b>	Cast Iron ASTM A126 Class B
<b>Stop Pin</b>	Stainless Steel AISI 416
<b>Hinge Pin</b>	Stainless Steel AISI 416
<b>Seat</b>	EPDM
<b>Pin Retainer</b>	Stainless Steel AISI 416
<b>Gasket</b>	PTFE
<b>Washer</b>	PTFE
<b>Spacer</b>	PTFE
<b>Disc</b>	Stainless Steel ASTM CF8
<b>Spring</b>	Stainless Steel AISI 304
<b>Lifting Pin</b>	Carbon Steel (Not Shown, only for 8", 10"&12')

## Notes:

Design and material are subject to change without notice.

## Dimensions (mm/inch)

Size	100mm/4"		150mm/6"		200mm/8"		250mm/10"		300mm/12"	
	mm	inch	mm	inch	mm	inch	mm	inch	mm	inch
A	93	3-11/16	105	4-1/8	121	4-3/4	154	6-1/16	187	7-3/8
B	172	6-3/4	220	8-11/16	280	11	340	13-3/8	410	16-1/8
C	136	5-3/8	178	7	230	9-1/16	285	11-1/4	338	13-5/16
Weight (kg)	8.4		13.5		23		42		68	