

Technical Features

- **Size:** 2", 2.5", 3", 4", 5", 6", & 8"
- **Working Pressure:** 450PSI
- **Sensitivity:**
 - FM: 1. No-alarm flow $\leq 15\text{L/min}$
 - 2. Alarm flow $> 15\text{L/min}, \leq 75\text{L/min}$
 - UL: 1. No-alarm flow $\leq 15\text{L/min}$
 - 2. Alarm flow $> 15\text{L/min}, \leq 37.5\text{L/min}$
- **Capacity of Switch Contacts:**
 - AC 125/250V 8A
 - DC 24V 3A
 - DC 30V 2.5A
- **Working Temperature:** 0-49°C
- **Steel Pipe:** SCH10 or 40
- **0-90 Seconds Field Replaceable Retard**



Technical Information

I. Overview

The vane type water flow switch use in wet pipe systems only. Water flow in the pipe deflects a vane, which produces a switched output usually after a specified delay.

II. Main Components

LF-WFS-450 series water flow indicator is mainly composed of the saddle, blade rack, bottom plate, outer cover, Air delay device, micro-switch, junction box, etc.

1. The main outline drawing is shown in Figure 1 Outline Drawing.
2. Main dimensions of water flow indicator are shown in Table 1.
3. Materials of the main components are shown in Table 2.

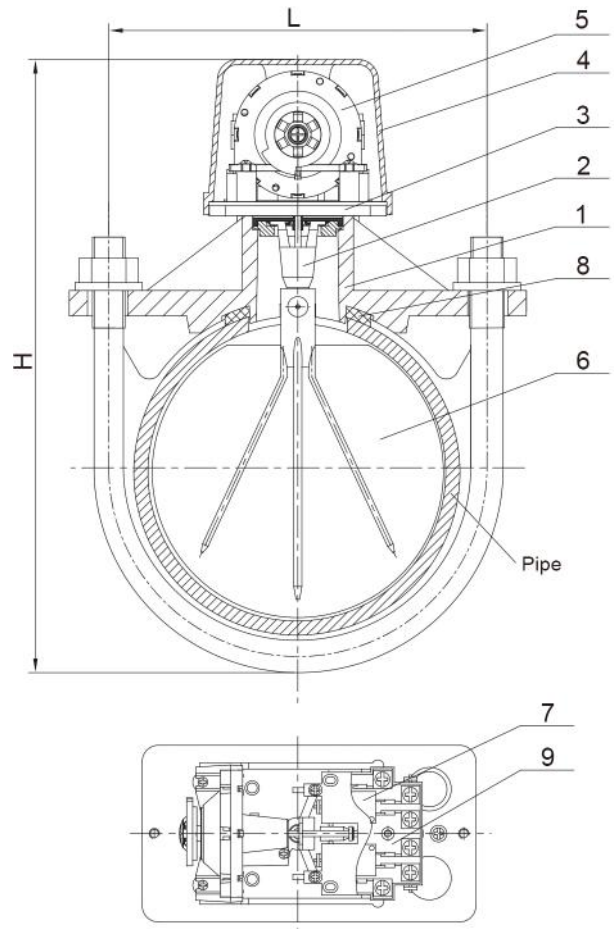

Dimentions

Model	Specification	INCH	L	H
LF-WFS-450	DN50	2"	85	188
LF-WFS-450	DN65	2.5"	92	200
LF-WFS-450	DN80	3"	106	220
LF-WFS-450	DN100	4"	134	245
LF-WFS-450	DN125	5"	162	272
LF-WFS-450	DN150	6"	189.5	298
LF-WFS-450	DN200	8"	240	350

Table 1
Figure 1 Outline Drawing

Installation and Debugging as well as Precautions

Installation of water flow indicator:

at the pre-set installation position, use a taper to drill on the main pipeline and remove burrs according to the product specification; roll up the blade into a small size and put it into the pipeline, install the U-shaped bolt and fasten it up with two fastening nuts, and the specific installation drawing is shown in Figure 2.

Materials of Main Components

No.	Name	Materials
1	Body	Ductile Iron
2	Blade Rack	SS304+EPDM
3	Bottom Plate	SS304
4	Outer Cover	Aluminum
5	Air Delay Device	Component
6	Blade	LLDPE
7	Micro-switch	Component
8	Sealing Gasket	EPDM
9	Junction Box	PC

Table 2

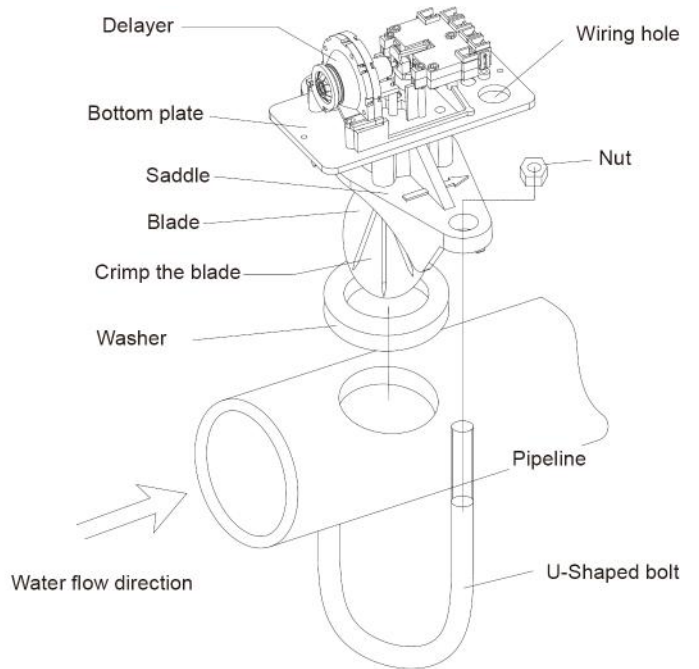

Figure 2 Installation Drawing

The typical wiring diagram is shown in Figure 3

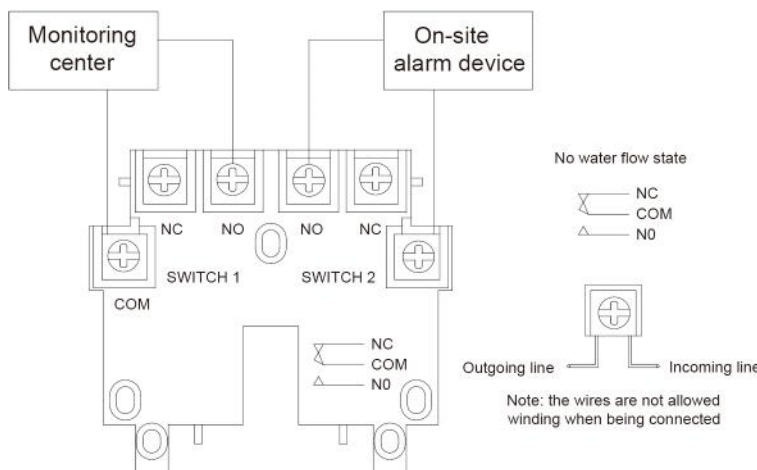

Figure 3

The hole size is shown in Table 3

Specification	Hole Size
DN50, DN65	32+2mm
DN80-DN200	51+2mm

Table 3