

GENERAL DESCRIPTION

The model LF-ESC-2 recessed escutcheons are designed for a decorative recessed installation with certain pendent and horizontal sidewall sprinklers. They are intended for use in areas with finished ceilings or walls.

TECHNICAL DATA

Physical Characteristics

Thread size.....DN15 1/2" NPT

Material.....Cold-roll Steel

Net weight.....32g

Surface Finishes

1. Chrome plated*
2. White coated

Note: *Standard Supply



DIMENSIONS

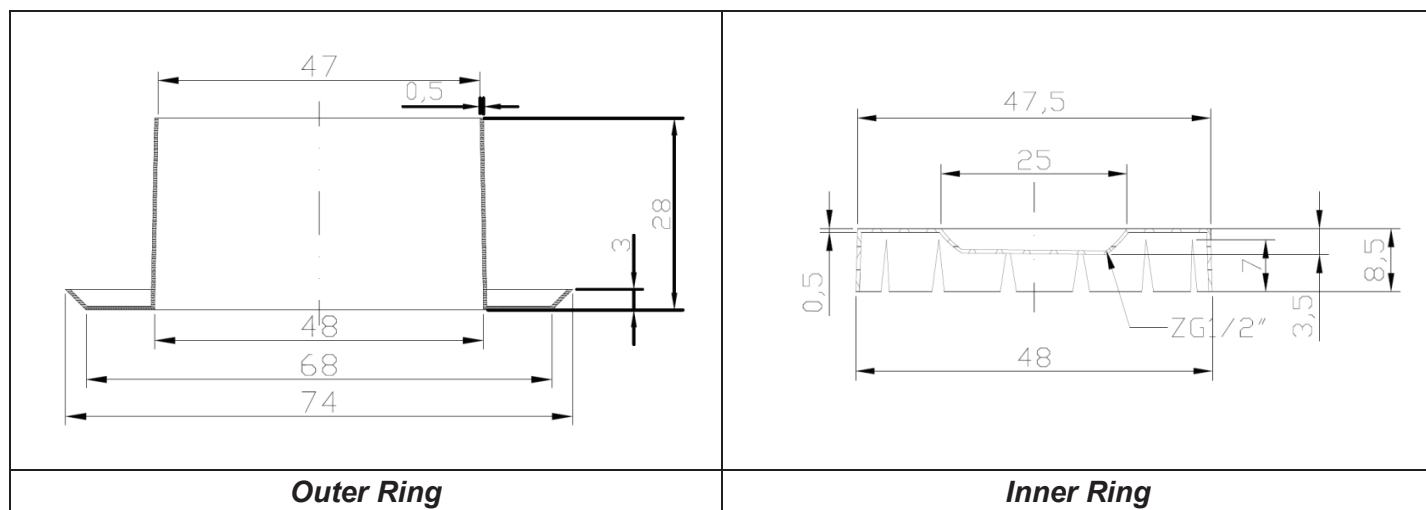

INSTALLATION

Step 1: Install the piping and cut the sprinkler nipple to position the opening in the ceiling or wall.

Step 2: Attach the escutcheon inner ring to the sprinkler by hand-turning it clockwise onto the sprinkler threads.

Step 3: Apply a small amount of pipe-joint compound or PTFE tape to the external threads of the sprinkler, avoiding build-up in the sprinkler inlet.

Step 4: Use a special sprinkler wrench to install the sprinkler into the coupling, avoiding over-tightening or damage to the sprinkler parts.

Step 5: Test the entire sprinkler system after installation, ensuring compliance with installation standards and proper tightening of the sprinkler.



Double Plate Fire Sprinkler Escutcheon

Model: LF-ESC-2

Step 6: Remove protective caps and bulb shields after finishing the wall or ceiling work, ensuring no potential for damage to the sprinkler.

Step 7: After installing the ceiling or wall with the required opening size, press on or thread on the outer escutcheon ring until the flanges touch the surface of the ceiling or wall.